



— Innovative, Elegant & Robust Solutions —

Hyden Engineering Pty Limited
1/48 Racecourse Road
RUTHERFORD NSW 2320
Telephone: (02) 4932 0111
Facsimile: (02) 4932 0222
E-mail: hyden@hydeneng.com.au

ABN: 17 129 010 902

ENVIROSPRAY Component Manual

Manual Number: 06500987C

Manual Date: February 2014

ENVIROSPRAY®

Spray Head HYDEN407



Contents

| Reference Number | Topic | Page Number |
|-------------------------|---------------------------------------|--------------------|
| 1 | Spray Head HYDEN407 | 3 |
| 1.1 | Description | 3 |
| 1.2 | Ordering Code | 3 |
| 1.3 | Components | 4 |
| 1.3.1 | Major Component Identification | 4 |
| 1.3.2 | Sub-assembly Component Identification | 5 |
| 1.3.3 | Component Breakdown | 6 |
| 1.4 | Service Information | 7 |
| 1.4.1 | Service Interval | 7 |
| 1.4.2 | Service/repair Kit | 7 |
| 1.5 | Adjustment of spray outlet | 8 |

1 Spray Head HYDEN407

1.1 Description

The Enviro-spray™ HYDEN407 Spray Head is a hydraulically controlled spray head producing a broad spray pattern. Multiple spray heads are generally used and when integrated into an Enviro-spray system with a water-module, spray control box and electronic control system they will provide an efficient and reliable dust suppression system.

1.2 Ordering Code

The following table shows the available options for the HYDEN407 spray head. The associated codes are also listed so a part number can be formed, this part number can then be used to order the product.

| HYDEN407- | | A | A |
|-------------------------------|--|----------|----------|
| Product No | | | |
| Spray type | | | |
| Standard (approx 90°) | | A | |
| Wide (approx 135°) | | B | |
| 90° with 50% stroke remaining | | C | |
| 90° with 30% stroke remaining | | D | |
| Gauge option | | | |
| No pressure gauge | | | 0 |
| Pressure gauge kit included | | | A |

1.3 Components

1.3.1 Major Component Identification

The following picture illustrates the components for a HYDEN407 spray head. Identified are the major components and service type components within the assembly. Part numbers for these components can be found in section 1.3.3 using the references listed below.

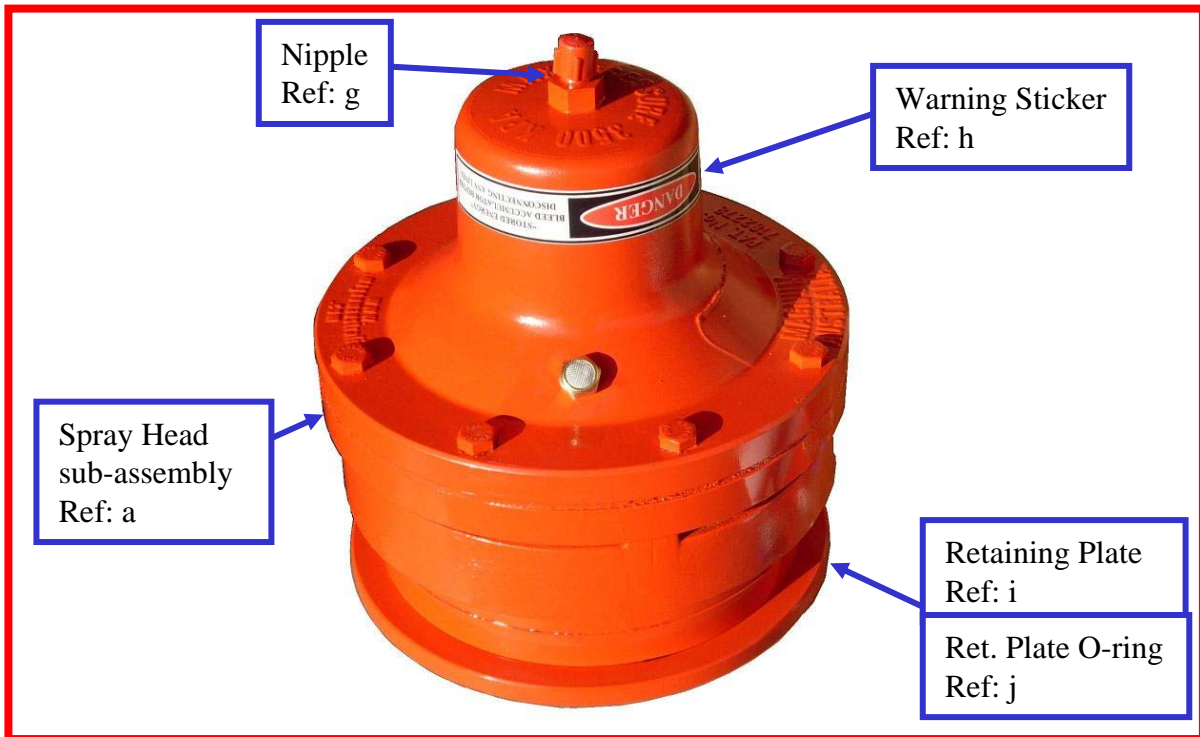

Gauge and associated components (where fitted):

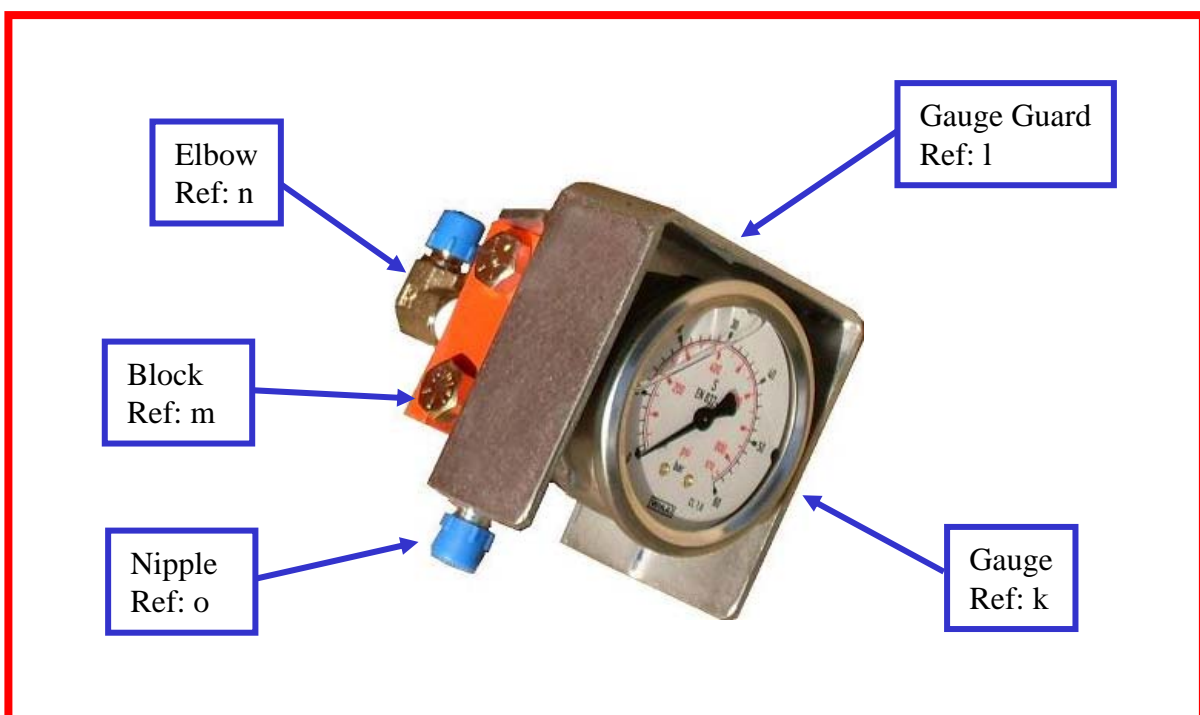

1.3.2 Sub-assembly Component Identification

The following picture illustrates the components for the 1019H spray head sub-assembly. Identified are the major components and service type components within the assembly. Part numbers for these components can be found in section 1.3.3 using the references listed below.

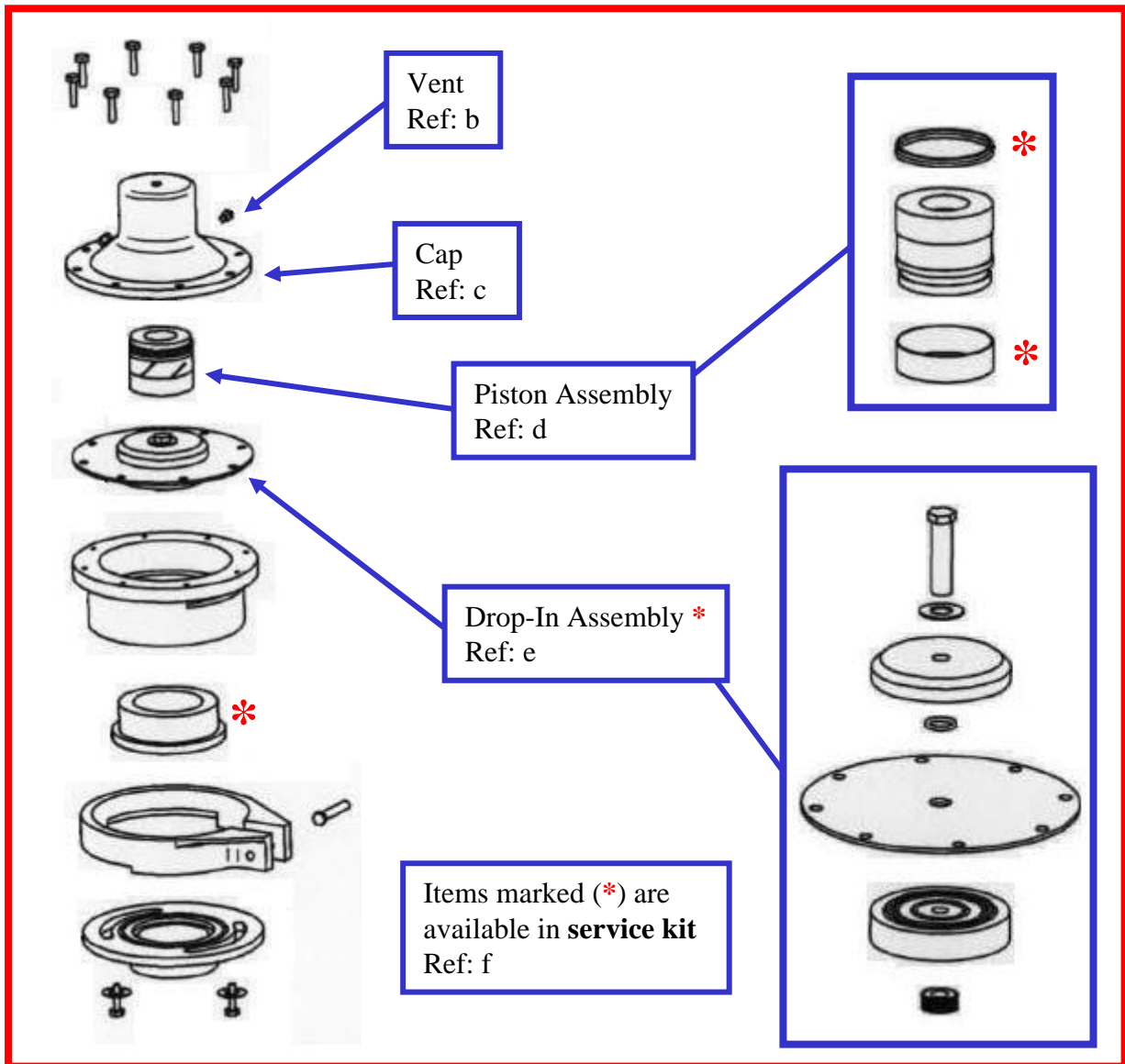

1.3.3 Component Breakdown

The following table lists the major components with their part numbers. The list only includes major components and components typically required for maintenance. If required, further component details can be provided by contacting Hyden Engineering.

| Ref | Description | Qty | Part / Assembly | Sub Component |
|---|------------------------|-----|-----------------|---------------|
| a | Spray head | 1 | 1019H | |
| b | Vent | 1 | | 80H-0002 |
| c | Cap | 1 | | 300206H |
| d | Piston assembly | 1 | | 80H-AL-PA-010 |
| e | Drop-In assembly | 1 | | 1019D-DA |
| f | Service kit | - | | 1019H-RK |
| g | Nipple (full stroke) | 1 | S90-0709 | |
| g | Nipple (50% remaining) | 1 | HY-2897AAA | |
| g | Nipple (30% remaining) | | HY-2991AAA | |
| h | Warning sticker | 1 | HY-2014AAA | |
| i | Retaining plate | 1 | HY-2031ABA | |
| j | Retaining plate o-ring | 1 | BS247 | |
| The following components only apply when gauge optioned | | | | |
| k | Gauge | 1 | SPG063-60-1-RBU | |
| l | Gauge guard | 1 | HY-2366AAA | |
| m | Block | 1 | HY-2353AAA | |
| n | Elbow | 1 | S8N-0407 | |
| o | Nipple | 1 | S7N-0407 | |

1.4 Service information.

The Spray heads run on oil supplied from the hydraulic tank; and as such if the tank is contaminated the sprays will need to be serviced.

1.4.1 Service Interval

•500 Hours

- Inspect for hydraulic or water leakage. If leakage is present; repair as required or send to Hyden Engineering for repair.
- Remove vent, clean and re-fit.
- Inspect gauge.

1.4.2 Spares/Repair Kit.

The HYDEN639-AB Spar head repair kit is available from hyden; these kits contain critical spares in a carry case with pictorial labeling to indicate re-order part numbers and quantities. The kit contains the below parts.

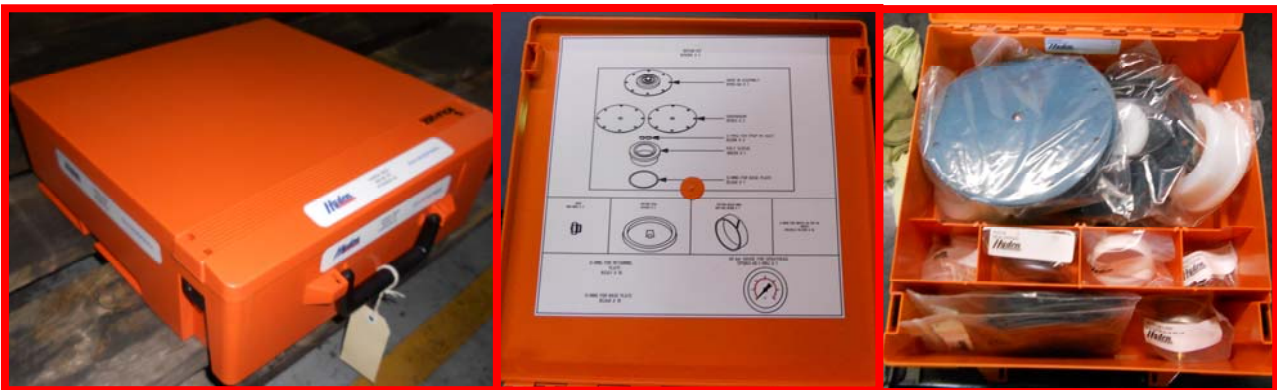

| | |
|-------------------|----------------------------|
| 1019H-RK | 2 |
| | REPAIR KIT HYDRAULIC |
| 80H-0002 | 2 |
| | VENT |
| 80H-WR-30308 | 1 |
| | WEAR RING |
| ES247 | 10 |
| | O-RING 70-DURO |
| ES348 | 10 |
| | O RING |
| HY-3009AAA | 1 |
| | STICKER SET SPRAY HEAD KIT |
| M1 1.0X2.5-70-FKM | 10 |
| | O-RING VITON |
| R44166 | 3 |
| | SEAL PISTON |
| RC003-SOLID-LID | 1 |
| | RC003 KIT BOX |
| SPG063-60-1-REU | 1 |
| | GAUGE 60-BAR REAR |

1.5 Adjustment of spray outlet.

The Spray heads have an adjustment ring which allows for 2 thicknesses of spray outlet. This can also be used to reduce the width of the fan, as seen below.



Adjustment ring.

Thin Slot



Thick Slot.

